



PHOTOS: ERIC MARCUS PHOTOGRAPHY

natural & easy-care

A VACATION IDYLL REFLECTS ITS BEACHFRONT SETTING

WISH LIST

- Organized space for vacation living
- Multi-use center island
- Durable, sustainable materials

Architect Steve Mouzon wanted this house, built on spec as a family vacation house in the new master planned community of Alys Beach, Florida, to be as clean-lined as possible. So, inspired by Thomas Jefferson's design of his beloved Monticello, Mouzon tucked as many of the home's systems out of sight and into walls as possible. Designer Beth Dillard took a similar approach to designing the interior, including the kitchen shown here, which opens to a dining room, and has views of a courtyard and master garden. The courtyard, in fact, was very important in this home and others at Alys Beach, which was designed by the Miami firm Duany Plater-Zyberk & Company (DPZ), who designed the beachfront community of Seaside, Florida, more than 30 years ago. That community reintroduced the importance of the front porch as a place to gather and get to know neighbors. But at Alys Beach, DPZ looked to Bermudian architecture and Guatemalan courtyards so that homeowners would have private outdoor spaces. Besides its interior and exterior views, the kitchen was designed to be easy to care for so that bare, sandy, wet feet wouldn't hurt floors or furnishings—and so that entertaining would be relaxed. To make that possible, Dillard used simple, natural, easy-care surfaces and furnishings.

Reclaimed red gum, waxed for durability, was used on kitchen cabinets and walls to add a natural feeling. Countertops were surfaced in French limestone that was also honed to fit with the natural, nonshiny look; walls were given a Venetian plaster finish that was painted off-white for reflecting light, and the floor was paved in a practical Dominican shell stone that was repeated in other rooms. To add some punch, a large mansard-style hood was built above the range, and two pendant lights have big woven shades in the same scale. A different sort of punch—modern and hip—was introduced with the stainless steel-fronted appliances and the aluminum stools that allow vacationers to saddle up to the island and grab a bite or converse with the cook, even in swimsuits. Counters, with storage, in front of windows overlooking the courtyard can be used for eating, too.



Sometimes the simplest layout is the best. Here, the classic work triangle keeps the range, sink and refrigerator/freezer near one another.

ABOVE LEFT: The large hood and woven shades are in sync scalewise and add visual punch.

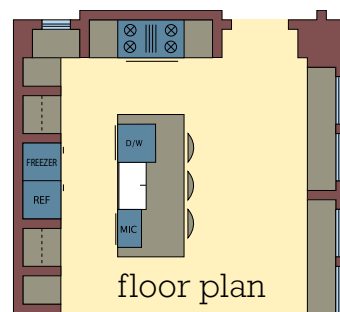

DESIGNER:

Beth Dillard
Notre Maison Design Group
P.O. Box 611203
Rosemary Beach, FL 32461
850-231-0077
www.notremaisondesigngroup.com

ARCHITECT:

Stephen A. Mouzon
1253 Washington Avenue, Suite 222
Miami Beach, FL 33139
786-276-6000
www.mouzon.com

LOCATION: Alys Beach, FL

DIMENSIONS: 15' x 14'

>>> SPECIAL FEATURES:

Dominican shell stone floors; Red gum cabinetry; Limestone countertops

PRODUCTS USED:

- **Cabinetry:** Handscraped, waxed gum, from Carl Fuller Cabinetry, Tallahassee, FL
- **Range, hood, microwave:** Thermador
- **Sink:** Blanco America
- **Faucet:** Kohler

- **Refrigerator/freezer:** Sub-Zero
- **Disposal:** In-Sink-Erator
- **Dishwasher:** Bosch
- **Countertops:** Honed French limestone
- **Floor:** Dominican shell stone
- **Walls:** Hand-rubbed Venetian plaster
- **Shades:** IKEA, Leran
- **Cabinet hardware:** Rocky Mountain
- **Bar stools:** Magis, Déjà Vu line

